

Quality and Training Tips 11/21/2025

Last Modified on 11/25/2025 4:52 pm EST

Washington Radiology Training Tips 11/21/2025

CT Exam Scheduling:

- CT exam must be scheduled a **minimum of 5 business days out**, unless the patient has:
 - **Medicare**, or
 - **BCBS Federal**These plans **do not** require pre-authorization.
- Be sure to **collect complete provider details** when scheduling CT exams. This information is required by the pre-authorization/certification team.

[? Pre-Authorization Requirements by Insurance | Washington Radiology Contact Center](#)

DEXA Exam Scheduling:

- Please send an email to the **Sterling** location for patients requesting to schedule a **bone density (DEXA)** exam at that location.
- Current availability is **6-8 months out**.
- Emails should be sent to:
 - Lead PSR: rachelle.davis@washingtonradiology.com
 - Center Director: samantha.nibblins.washingtonradiology.com
 - CC: All_WR_CC_Leadership@washingtonradiology.com

Please Slow Down:

- Reading is fundamental - especially when scheduling.
- Please take a moment to carefully review any **exam warnings or restrictions** that appear in eRAD.

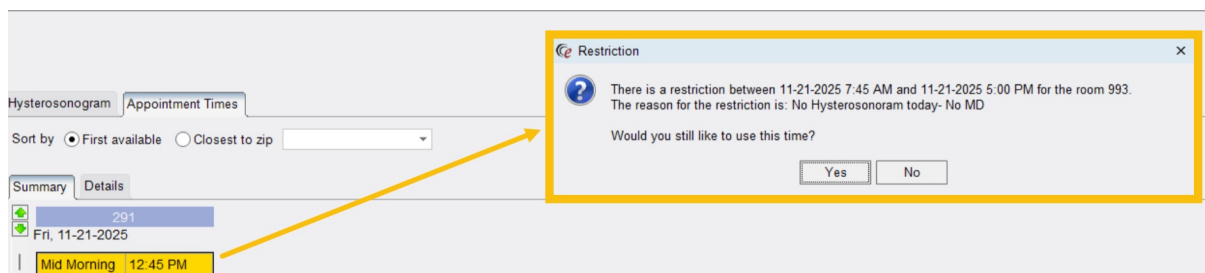

- Slowing down helps prevent avoidable scheduling errors and ensure a smoother experience for both patients and centers.

Thank You!

As we head into Thanksgiving week, we want to extend a heartfelt thank you for everything you do. We're deep in our busiest season, and your professionalism, attention to detail, and patience truly shine. You make a meaningful difference for our patients every single day, and your dedication does not go unnoticed.

We hope each of you gets a moment to rest, reset, and enjoy time with the people you care about.

PUBLISHED: 11/25/2025
